

700 Series Compressors

(CA-711, CA-721, CA-713, CA 723 & CA-725)

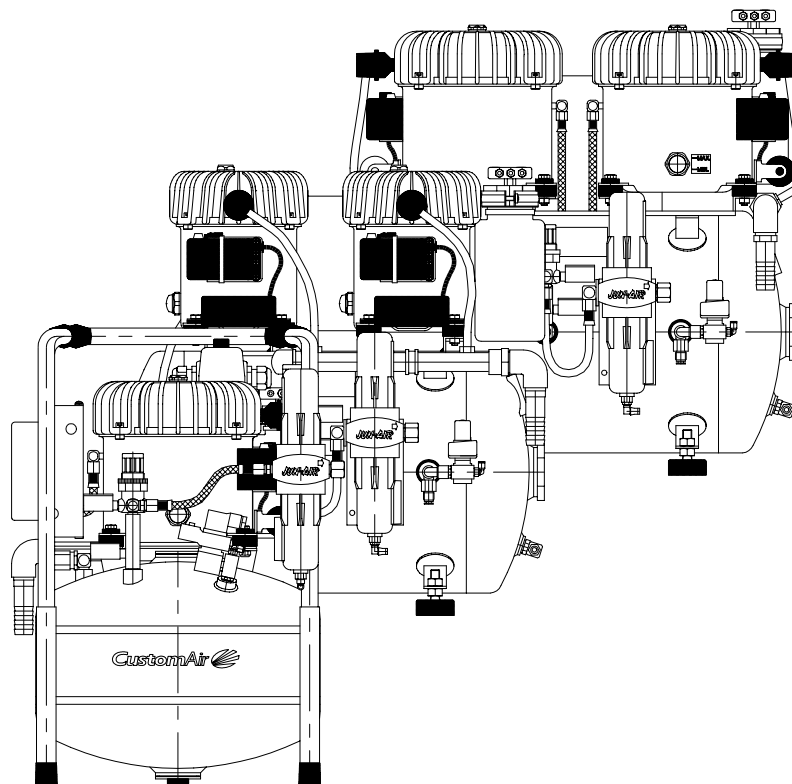

Installation, Operation and Care Manual

Section I Introduction

Features/Benefits	2
Specifications	2
Model CA-711 / CA-721	3
Model CA-713 / CA-723	4
Model CA-725	5

Section II Pre-installation

Unpacking	6
Placement	6

Section III Installation

Unit Connections	7
Grounding Instructions	8
Extension Cords	9

Section IV Operation

General Operation	10-11
Running Time	11
Automatic Reset Protector	11

Section V Care

Maintenance Schedule	12
Cleaning Compressor	12
Checking Oil Level	13
Changing Oil	13
Replacing Intake Filter	14
Testing Safety Valve	14
Inspecting for Leaks	14-15
Cleaning Non-return Valve	15
Checking / Replacing Unloader Valve	15

Section VI User Service Information

Service Instruction	16
Troubleshooting Chart	16-17

Section VII Parts List / Diagrams

Model CA-711 / CA-721 Parts List	18
Model CA-711 / CA-721 Diagram	19
Model CA-713 / CA-723 Parts List	20
Model CA-713 / CA-723 Diagram	21
Model CA-725 Parts List	22
Model CA-725 Diagram	23

Product Support Services

24

This manual contains installation, operation and care instructions and user service information for the CustomAir 700 Series Compressors.

The oil-lubricated 700 Series Compressors are designed to provide trouble-free service when installed, operated and cared for according to the procedures set forth in this manual.

Features/Benefits

- **Quiet Operation** — With an acoustically engineered motor and air path with four sound-muffling pressure chambers, the 700 Series Compressors make sounds no louder than normal conversation.
- **Close Installation** — Quiet operation allows closer installation to the operatory which means lower plumbing costs and easy accessibility.
- **Exceptional Air Quality** — Specially designed combination filter produces odorless air and filters handpiece destroying particulates to 0.01 microns.
- **Reduced Compressed Air Temperature** — An exclusive fan-cooled radiator reduces compressed air temperature by 50%.
- **Longer Compressor Life** — Pistons and cylinders are manufactured to extremely precise tolerances.
- **Easy Maintenance** — Holding tank and filtration system drain automatically. Exclusive hour meter makes it simple to follow service schedule.

Specifications

Model	CA-711	CA-721	CA-713	CA-723	CA-725
Users (max.)	1	1	3	3	5
Voltage (V/Hz)	120/60	240/60	120/60	240/60	240/60
Power (amps.)	6.2	2.9	12.4	5.8	11.6
Weight: (kg.) (lbs.)	37 82	37 82	54 119	54 119	84 185
Dimensions: (mm) <i>L x W x H</i> (in.)	378 x 466 x 610 14.9 x 18.4 x 24	378 x 466 x 610 14.9 x 18.4 x 24	580 x 463 x 629 22.9 x 18.2 x 24.8	580 x 463 x 629 22.9 x 18.2 x 24.8	602 x 563 x 646 23.7 x 22.2 x 25.4
Noise Level (db)	45	45	48	48	56
Pump Time (sec.) <i>0-120 psi</i>	270	270	225	225	110

NOTE: Pump Time plus/minus 10%. Average at 20°C/68°F motor start temperature

Model CA-71 I/CA-72 I

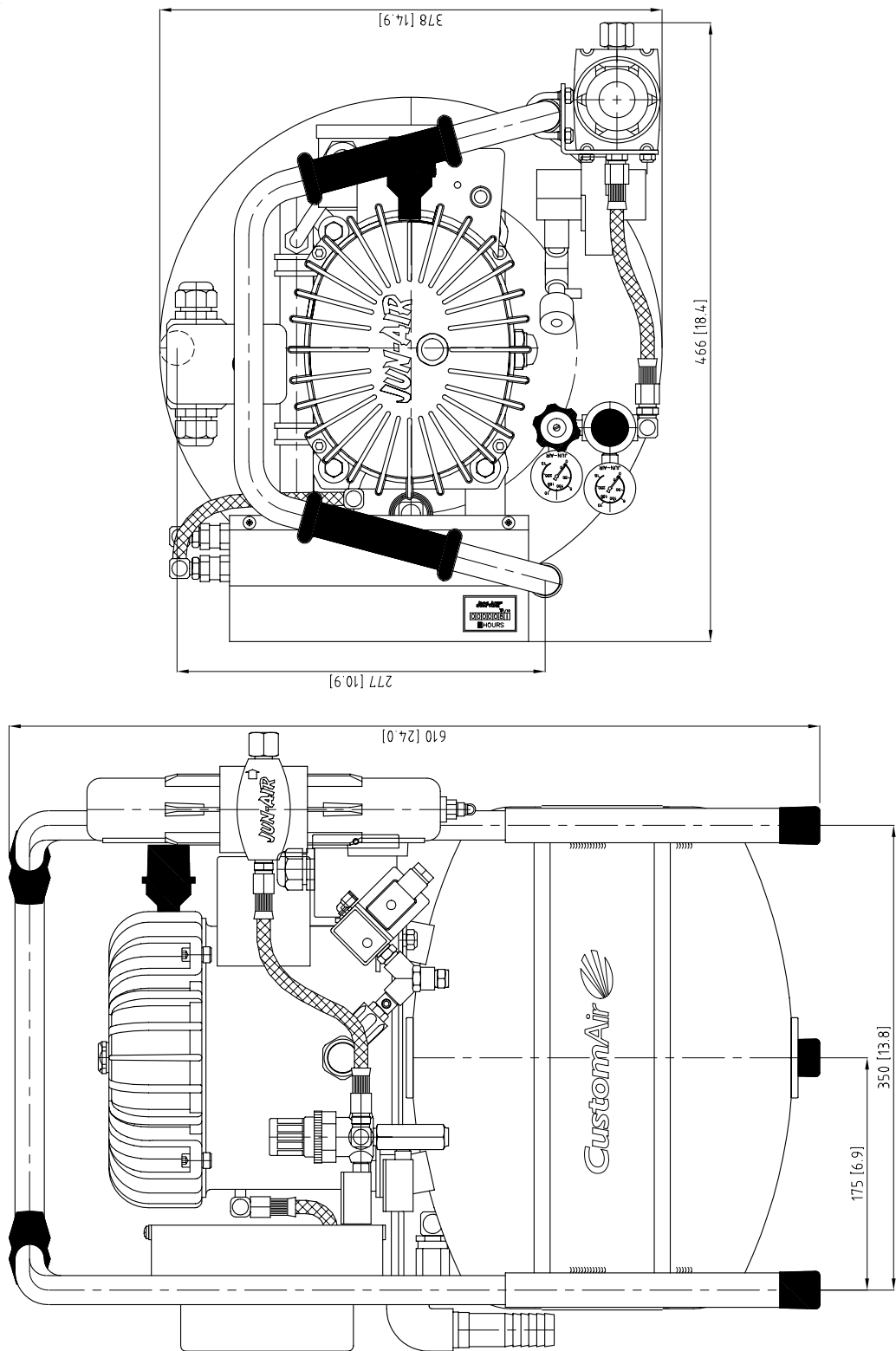

Model CA-713/CA-723

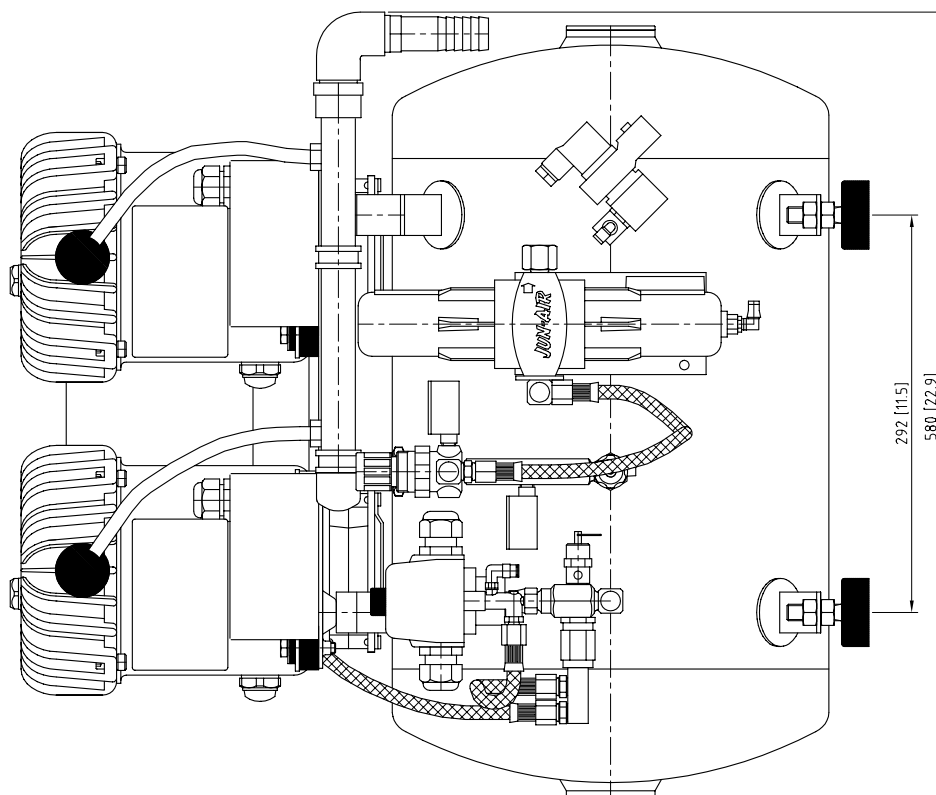
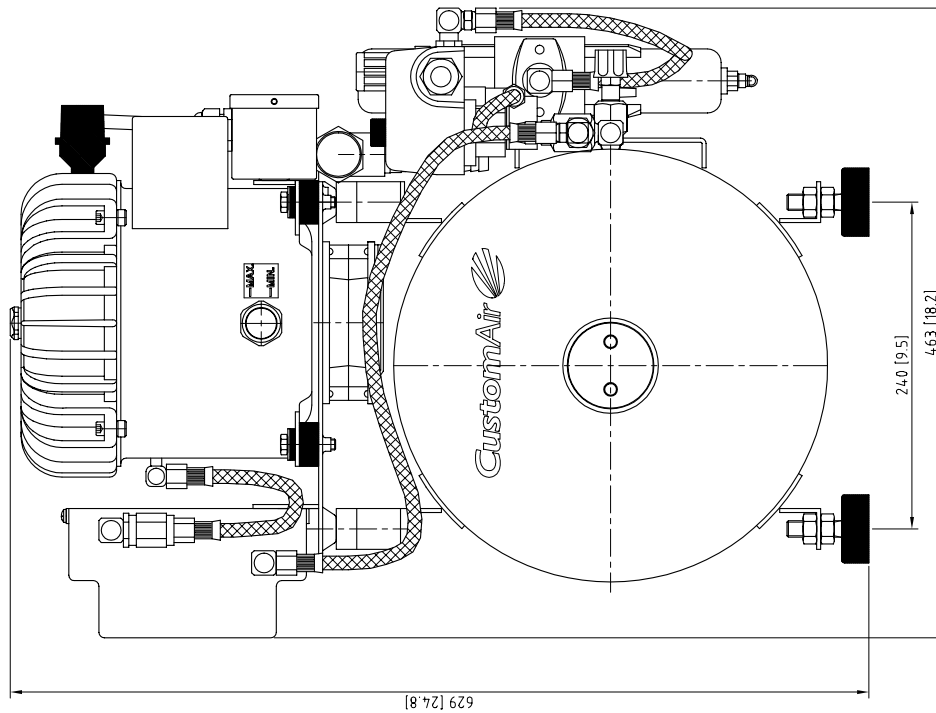

Model CA-725

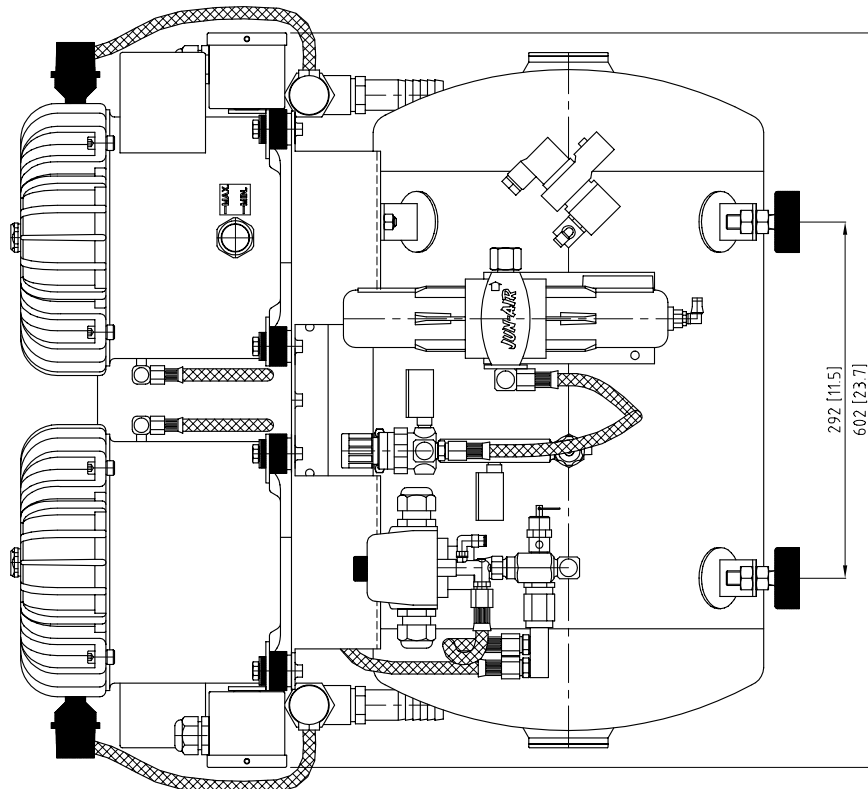
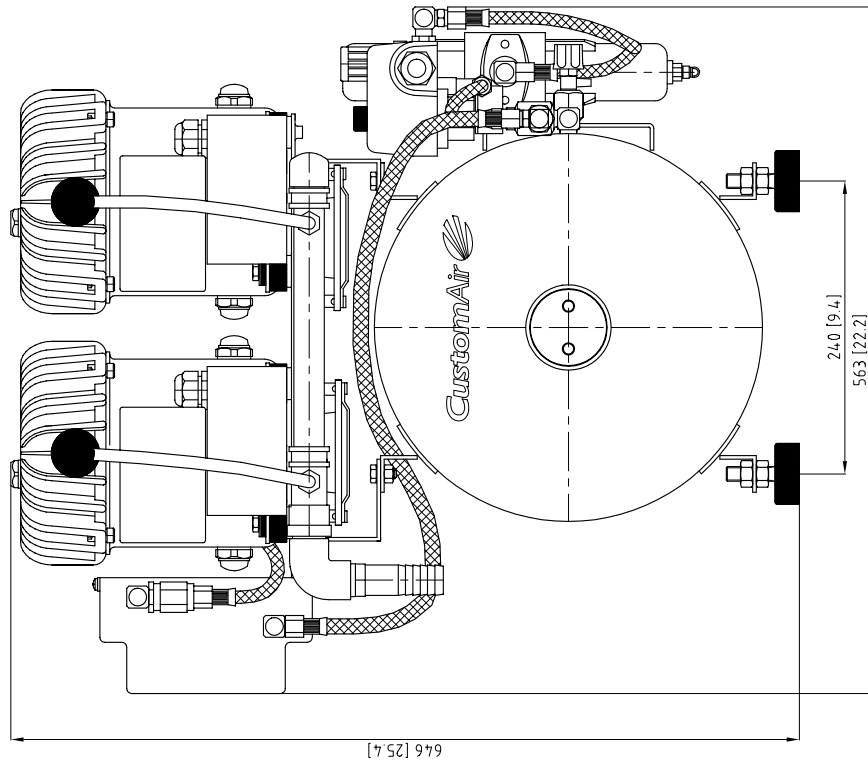

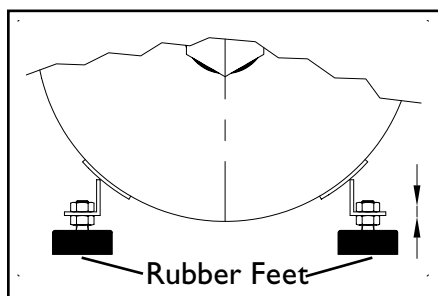
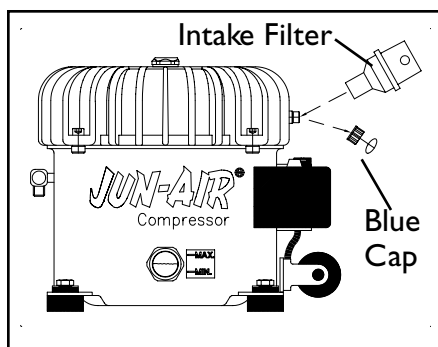

Unpacking

1. Carefully remove the compressor from its shipping carton.
2. Visually inspect the unit for shipping damage. Contact the freight carrier and supplier immediately if the unit has shipping damage. *(See Product Support Services, Page 24.)*
3. Replace the blue cap on the air intake tube with the intake filter. *(See illustration at left.)*

Placement

1. Place the compressor in a dust-free, dry, cool and frost-free room.

— CAUTION —

The compressor is for **indoor use only** --
NOT FOR OUTDOOR USE!

2. **Do not** install the compressor in a closed cupboard, unless adequate openings for ventilation are available at the top and bottom of the unit (*minimum 500 cm² / 77.5 in² each*).

— WARNING —

When spraying flammable liquid, there may be **danger of fire or explosion**, especially in closed rooms.

3. When positioning the compressor, ensure the oil in the oil level glass and the liquid in the drain bottle are visible.
4. Models CA-713, CA-723 and CA-725 have four adjustable rubber feet to assure the unit stands firmly on the floor. *(See illustration at left.)*

— WARNING —

Place the compressor out of children's reach and **never leave children unattended** when the compressor is in use.

Unit Connections

The following information will assist in making a quick, easy and quality installation. However, if there are any questions, contact a CustomAir technical service representative at **1-866-DTE-INFO** (1-866-383-4636).

— WARNING —

Unless directions are followed and the original spare parts used, physical injury or property damage may result.

NOTE: *Make certain the blue cap on the air intake tube was replaced with the intake filter.*

1. Make sure the operating voltage of the compressor corresponds to the voltage of the socket. (*Refer to Specifications, Page 2.*)

— CAUTION —

Only connect the compressor to installations with the correct voltage stated on the motor plate

2. Ensure the circuit is properly protected according to the Specifications on Page 2.

IMPORTANT NOTE: *The air consumption of the equipment used with the compressor **must** be sized properly to the compressor/number of users.*

— CAUTION —

Only connect equipment suitable for the maximum pressure stated on the tank pressure gauge.

3. Connect the pressure hose to the filter outlet.
4. Connect the plug/cable. (*See Grounding Instructions, Page 8.*)

— NOTICE —

When using the compressor in connection with vital equipment, an alternative air source should be available in case of a defect in the compressor.

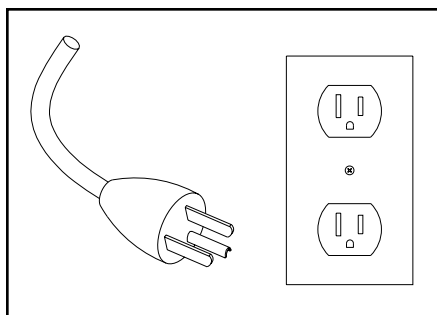

Grounding Instructions

— WARNING —

Risk of electric shock could occur as a result of improper grounding plug installation.

To reduce the risk of electric shock, this product **must** be grounded. In the event of an electrical short circuit, grounding provides an escape wire for the electric current.

This product is equipped with a cord having a grounding wire with an appropriate grounding plug. *The wire with insulation having a green or green with yellow stripes outer surface is the grounding wire.*

1. The plug **must** be plugged into a properly installed and grounded outlet, which is in accordance with all local codes and ordinances.
2. If the plug provided does not fit the outlet, **do not** modify it in any way. Have a qualified electrician install the proper outlet.
3. If repair or replacement of the cord or plug is necessary, **do not** connect the grounding wire to either flat blade terminal.
4. Check with a qualified electrician or serviceman if the grounding instructions are not completely understood, or if there is any doubt whether the product is properly grounded.

For Grounded, Cord-Connected Products:

- **Rated less than 15 amps and intended for use on a nominal 120V supply circuit:**
 - a. This product has a grounding plug like the one depicted in the illustration on the left.
 - b. Make sure the product is connected to an outlet having the same configuration as the plug and no adapter should be used.
- **Intended for use on a circuit having a nominal rating of more than 120V:**
 - a. This product is factory-equipped with a specific electric cord and plug, which allows connection to a proper electric circuit.
 - b. If reconnecting on a different type of electric circuit, re-connection should be made by qualified service personnel.
 - c. Make sure the product is connected to an outlet having the same configuration as the plug and no adapter should be used.

Extension Cords (120V Units)

The use of an extension cord is **not advisable**. But if one must be used, it should meet the following recommendations:

- ✓ Use only a 3-wire extension cord having a 3-blade grounding plug and a 3-slot receptacle that will accept the plug on the product.
- ✓ Use an extension cord that is in good condition and heavy enough to carry the current the product will draw.
- ✓ For lengths less than 25 feet, No. 14 AWG extension cords should be used.

— CAUTION —

An undersized extension cord will cause a drop in line voltage and loss of power and overheating will result.

- ✓ If in doubt, use the next heavier gauge. *The smaller the gauge number - the heavier the cord.*

General Operation

The oil-lubricated 700 Series Compressor is very easy to operate and maintain. Observe the following simple instructions and the compressor will provide clean, high-quality air.

— WARNING —

Do not direct any air flow towards the body.

— CAUTION —

- **Do not** operate the compressor at ambient temperatures above 35°C/95°F or below 0°C/32°F.
- Always keep the compressor head in a vertical position during use and transportation.
- The compressor oil may be aggressive towards certain gasket materials used in pneumatic equipment. Use of Teflon™, Viton™, etc. is recommended.
- **Do not** use polycarbonate filter bowls.

1. Make sure the compressor is plugged into an appropriate outlet and is properly grounded.
2. Turn the compressor **on** at the pressure switch.

NOTE: *When the compressor is powered, ventilation will automatically follow and the compressor will automatically operate between 90-120 psig.*

— NOTICE —

If the compressor does not turn on, see the Troubleshooting Chart on Pages 16 and 17.

Section IV Operation



3. Turn the outlet cock **counterclockwise** to open.
4. To ensure a constant outlet pressure (80 psig), adjust the regulator to the correct pressure. Then press the regulating button **down** to lock the regulator.

— CAUTION —

Do not adjust the pressure switch to a higher pressure than the factory-set pressure. (8 bar/120 psig)

5. Read the pressure on the outlet gauge.
6. Read the pressure on the tank gauge.
7. Turn the compressor **on** at the main switch.
8. Turn the button on the main switch to position **1**, which is the normal factory pre-set.

Running Time

The compressor's maximum running time at 8 bar/120 psig is 50%. This is equivalent to a maximum running time of 15 minutes **on** and 15 minutes **off**. Any running time between these intervals is acceptable.

Automatic Reset Protector

The unit is equipped with a thermal protector that cuts off the compressor motor if the temperature is too high or the amps drawn by the unit exceeds a certain limit. The protector has an automatic reset. When the temperature of the motor drops under the cut-in value of the protector, the motor will automatically start operating.

— NOTICE —

If you need more information, contact DentalEZ Technical Service at **1-866-DTE-INFO** (1-866-383-4636).

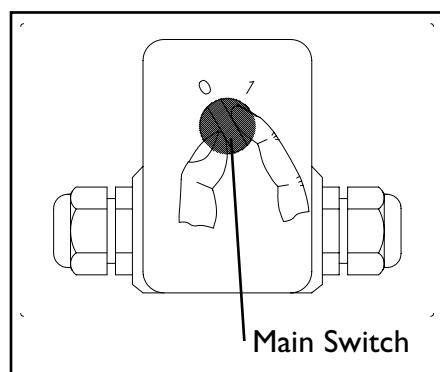
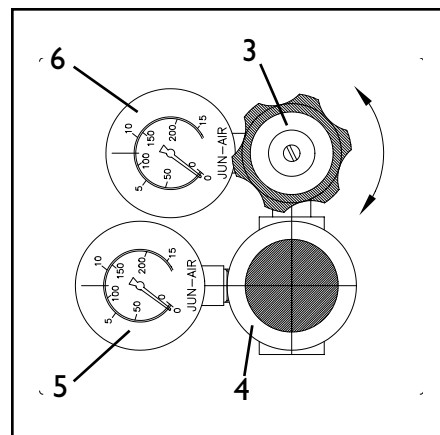

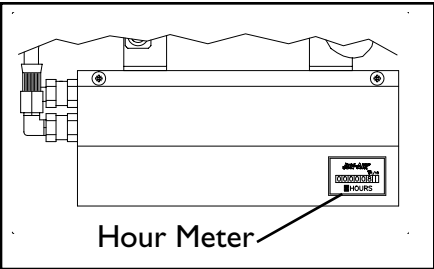

Maintenance Schedule

An hour meter is installed on the compressor. After one month of operation, observe the number of hours to determine the appropriate maintenance intervals for the activities listed in the chart below.

IMPORTANT NOTE: *In case of extreme operating conditions, e.g. dusty surroundings and/or high ambient temperature, the intervals indicated in the chart are reduced.*

Activity	Interval
Clean compressor. (Pg. 12)	100 hrs.
Check oil level. (Pg. 13)	100 hrs.
Change oil.* (Pg. 13)	12 mos.
Replace intake filter.** (Pg. 14)	1000 hrs.
Test safety valve. (Pg. 14)	1000 hrs.
Inspect for leaks. (Pg. 14-15).....	1000 hrs.
Clean non-return valve & replace O-ring. (Pg 15)	4000 hrs.
Check/Replace unloader valve. (Pg. 15)	Periodically
* In connection with motor repair, or in case the compressor is installed in a very dusty environment, oil change may be necessary more frequently but must take place at least every 12 months.	
** Consequently, if the conditions mentioned above exist, the intake filter should be changed at least every 12 months regardless of the hours of operation.	

— NOTICE —
Maintenance kits are available. Contact DentalEZ Customer Service at **1-866-DTE-INFO** (1-866-383-4636).

Cleaning Compressor

After approximately every 100 hours of operation, remove dust and oil remains from the exterior of the compressor.

IMPORTANT NOTE: *DO NOT USE HARSH CHEMICALS.*

Checking Oil Level

Check the oil level every 100 hours. During standstill, the correct level is between the maximum and minimum indications. If necessary, add or remove oil until the level is between the maximum and minimum lines.

Changing Oil

Oil change **must** take place at least every 12 months. *Refer to the maintenance activity chart on the opposite page for the appropriate oil changing interval.*

PN: JA4480000 Oil Suction tube

PN: JA5473000 Service kit w/2 btl. of oil, 1 O-ring f/rib cover

PN: JA5473010 Service kit w/4 btl. of oil, 2 O-rings f/rib cover

PN: JA5473020 Service kit w/6 btl. of oil, 4 O-rings f/rib cover

1. Remove the rib cover by loosening the four screws that secure it.
2. Using the suction tube, suck the oil from the housing. If dirt particles are present at the bottom of the motor housing, clean with a rag.

— IMPORTANT NOTE —

Waste oil **must** be handled according to the environmental rules enforced in the state.

3. Fill the motor with SJ-27 oil (approx. 0.75L).
4. Clean the edge of the casing and cover.
5. Check the rib cover's O-ring. *Change if damaged.*
6. Reattach the rib cover.
7. During operation, make sure the O-ring is properly in place making a 100% tight close between the housing and the cover.

NOTE: *For models with several motors, follow the same procedure.*

— CAUTION —

Always use SJ-27 oil because other types may cause serious mechanical damage to the compressor. Consequently, the warranty only applies if SJ-27 oil is used.

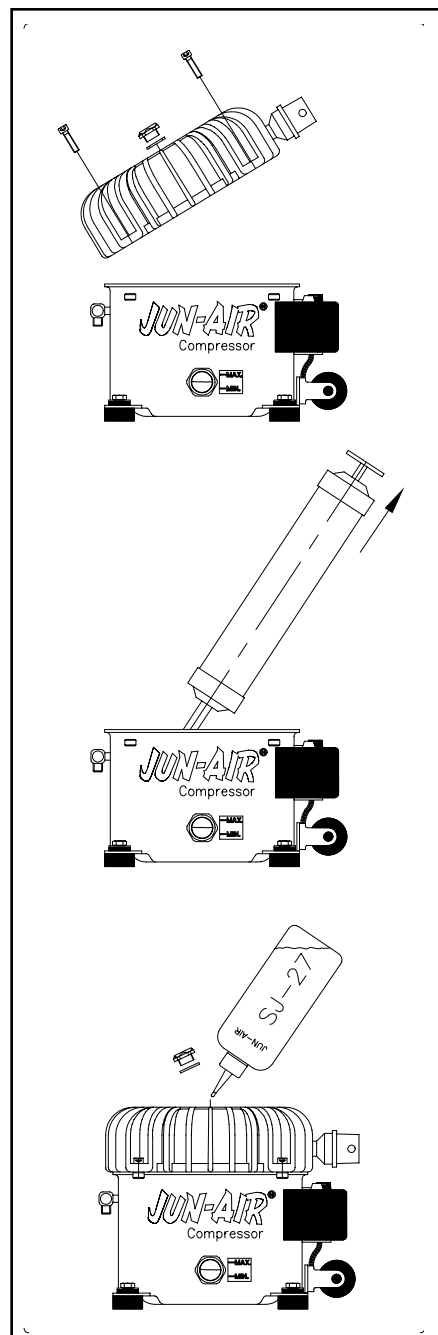
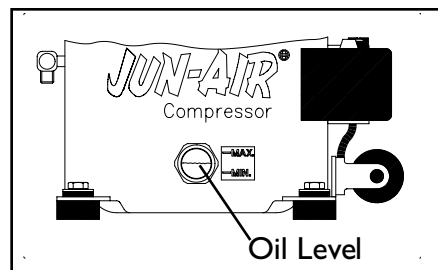

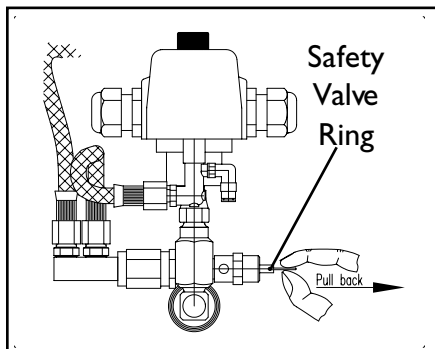
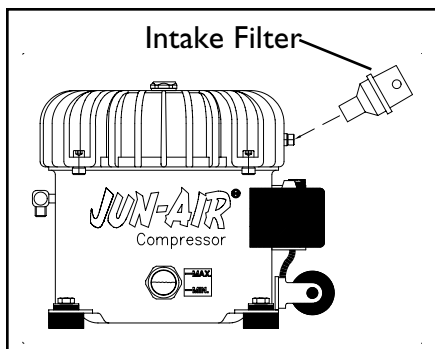

Replacing Intake Filter

Replace intake filter every 1000 hours. *Refer to the maintenance activity chart on Page 12 for the appropriate intake filter replacing interval.*

1. Turn the compressor **OFF** at the main switch and pull out the electrical plug.
2. Remove the intake filter from the air intake tube on the rib cover.
 - Model CA-711 has 1 intake filter
 - Model CA-721 has 1 intake filter
 - Model CA-713 has 2 intake filters
 - Model CA-723 has 2 intake filters
 - Model CA-725 has 4 intake filters
3. Press the new intake filter on the air intake tube.
4. Replace the tube from the remote air intake manifold.

Testing Safety Valve

Test the safety valve every 1000 hours.

1. Turn the compressor **ON**.

— WARNING —

The compressor is still connected to the power supply.

2. Pull the safety valve ring. *A very loud burst should be heard when air leaks from the safety valve. Otherwise, the valve is defective and must be replaced immediately.*

Inspecting for Leaks

Inspect for leaks every 1000 hours.

— IMPORTANT NOTE —

Always test the compressor when cold because the pumping time indicated refers to a cold compressor. Since the pumping time of a warm compressor is much longer, the result might be misleading.

1. Turn the compressor **OFF** at the main switch and pull out the electrical plug.
2. Disconnect the air lines, if any.

3. Open the regulator and let the pressure drop to 0 psig. Then read the pressure of the tank on the gauge.
4. Close the regulator.
5. Turn the compressor **ON** and measure the pumping time, i.e. how many seconds it takes until the tank's pressure reaches 120 psig and shuts off. Then read the pressure of the air tank on the gauge.
6. If the pumping time exceeds the seconds listed in Specifications on Page 2, turn the compressor **OFF** and locate/repair the leaks.
7. Contact DentalEZ Technical Service at **1-866-DTE-INFO** (1-866-383-4636), if the leaks cannot be repaired.
8. If the pumping time corresponds to the time indicated in the diagram on page 2, there are no leaks in the compressor.

Cleaning Non-return Valve

Clean the non-return valve every 4000 hours.

1. Turn the compressor **OFF** at the main switch and pull out the electrical plug.

IMPORTANT NOTE: *Before dismantling the non-return valve, empty all air from the tank.*

2. Dismount the non-return valve from the tank.
3. Disassemble the non-return valve and remove O-ring from piston.
4. Clean the non-return valve.
5. Fit a new O-ring in the non-return valve and reassemble.

Checking/Replacing Unloader Valve

Periodically check/replace the unloader valve.

1. Turn the compressor **OFF** at the main switch and pull out the electrical plug.
2. Open the regulator and let the pressure drop 0 psig.
3. Dismount the unloader valve from bottom of pressure switch.
4. Press the needle at the top of the unloader valve.

NOTE: *If the needle can't be pressed down, unloader valve is defective.*

5. Replace the unloader valve if defective. PN: JA6973300.

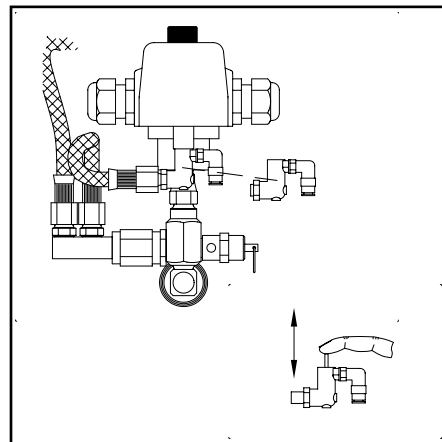
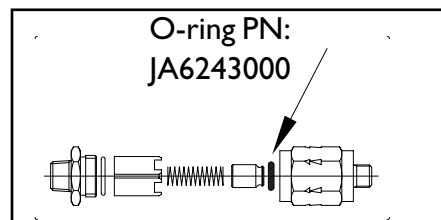
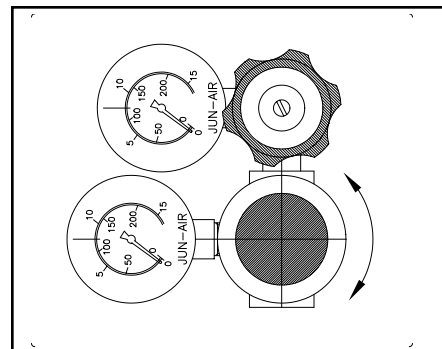

Service Instruction

The following troubleshooting charts should be used when attempting to isolate operational problems.

If the problem is not addressed or cannot be isolated by performing the suggested procedures, contact your local DentalEZ full-service dealership. (*See Product Service Support, Page 24.*)

Have the following product information available:

- Model Name _____
- Model Number _____
- Serial Number _____
- Installation Date _____
- Hour Meter Reading _____
- Dealer _____

— CAUTION —

- Always turn the power OFF before removing any parts from the compressor.
- Empty air from the air tank and ensure there is no pressure in the system before dismantling any parts.

Troubleshooting Chart

Symptom	Possible Cause(s)	Solution
Compressor does not start	No power from main supply	Check plug/cable. Check building's fuses.
	Button on pressure switch is on "0"	Turn pressure switch button to "1".
	Pressure in tank is too high. Compressor does not start until the pressure drops to the cut-in pressure on the pressure switch	Empty pressure in tank.
	The thermal protection has switched off the compressor because of overheating	When cooled, the compressor will automatically turn ON at a suitable operating temperature.
	The back pressure may be caused by a leaking non-return valve making the compressor air in the tank to leak back into the compressor motor.	Dismount the non-return valve and change the O-ring.
Loud noise from compressor	Most likely broken suspension spring(s)	Replace the spring and ensure the motor position is horizontal.
	The internal pressure pipe touches the rib cover or the cylinder block	Dismount the rib cover and bend the pressure pipe away.

Troubleshooting Chart continued

Symptom	Possible Cause(s)	Solution
Compressor starts but pressure does not increase	The cap on the intake tube has not been removed and replaced by the intake filter	Replace the cap on the intake tube with the intake filter.
	Intake filter clogged	Replace intake filter.
	Leaks in compressor or air lines	Check tubes, fittings and tools for leaks. <i>Use soapy water.</i>
	Clogged non-return valve	Clean non-return valve. Change O-ring.
	Air leaks from the unloader valve when the compressor is operating	Check or replace the unloader valve.
	Defective valve plate	Replace valve plate.
Compressor gets hot	Intake filter clogged	Replace the intake filter.
	Ambient temperature exceeds 35°C/95°F	Make sure there is sufficient ventilation.
	Fans are not working	Check wiring. Then check fan for movement or blade rotation.
	Compressor is overloaded	Disconnect some of the air tools.
	Leaks in compressor	Check tubes, fittings and tools for leaks. <i>Use soapy water.</i>
	Incorrect oil level	The oil level must appear in the oil level glass.
	Wrong type of oil was placed in the compressor	Use only SJ-27 synthetic lubricant, which has the correct viscosity.
Compressor operates even when no air is being used	Leaks in the compressor or leaks in the air lines in the office	Check tubes, fittings and tools for leaks. <i>Use soapy water.</i>
Compressor starts and stops more frequently than usual	More condensate in air receiver	Auto drain defective. Replace auto drain.
	Leaks in compressor or air lines	Check tubes, fittings and tools for leaks. <i>Use soapy water.</i>
Compressor does not switch on at 90 psig and does not switch off at 120 psig. <i>Read the gauge for pressure</i>	Pressure switch is defective	Replace pressure switch.

Model CA-711 / CA-721 Parts List

ID#	Description	Part No.	Qty.	ID#	Description	Part No.	Qty.
1	Tank 25L	JA3410200	1	22	Handle	JA5340000	1
2	Socket, 25 mm, black	JA6250000	3	23	Extension piece f/cock	JA7156100	1
3	Cross connector	JA7071400	1	24	Distributor f/non-return valve	JA5425000	1
4	Pressure switch	JA5075201	1	25	Bracket f/cooler	JA8112000	2
5	Safety valve, 135 psi ASME	JA5417000	1	26	Motor M6, 240V	JA2021100	1
6	Elbow, 1/4"	JA7180000	1	27	Motor M6, 120V	JA2710200	1
7	Non-return valve	JA5414500	1	28	Intake pipe f/remote air	JA5412705	1
8	Elbow, 1/8"	JA7190000	4	29	Intake filter	JA5412210	1
9	Double nipple, 1/4" x 1/8"	JA7025000	1	30	Flex pipe, 1/8", 20(22) cm	JA6420000	3
10	Auto drain, 240V	JA4799500	1	31	Unloader valve	JA6973310	1
11	Auto drain, 120V	JA4799600	1	32	Kit repl. valve plate M6 w/top	JA5470310	1
12	Outlet cock, 1/4"	JA5424000	1	33	Compressed air pipe complete	JA6490800	1
13	Regulator	JA4071020	1	34	Bushing, 1/4" x 1/2", NPT inside	JA7567300	1
14	Gauge Ø40, 0-16 bar, 1/8" down	JA5130000	2	35	Bushing, 1/2" x 3/4", NPT inside	JA7567400	1
15	Rapid fitting, O4 x 1/8"	JA4142200	2	36	Starting relay 240V M6	JA4523000	1
16	Bracket f/combination filter	JA8006500	1	37	Starting relay 120V M6	JA4524000	1
17	Bushing, 1/4" x 3/8"	JA7567000	1	38	Capacitor 70µF, 240V	JA5210000	1
18	Bushing, 1/4" x 3/8", NPT inside	JA7567200	1	39	Capacitor 160µF, 120V	JA5230000	1
19	Radiator & fan w/camtimer 240V	JA5445000	1	40	Overload protector, 240V	JA4520000	1
20	Radiator & fan w/camtimer 115V	JA5445100	1	41	Overload protector, 240V	JA4521000	1
21	Combination filter	JA4080000	1	42	Maintenance kit, CA-711/721	64568176	1

Model CA-711 / CA-721 Diagram

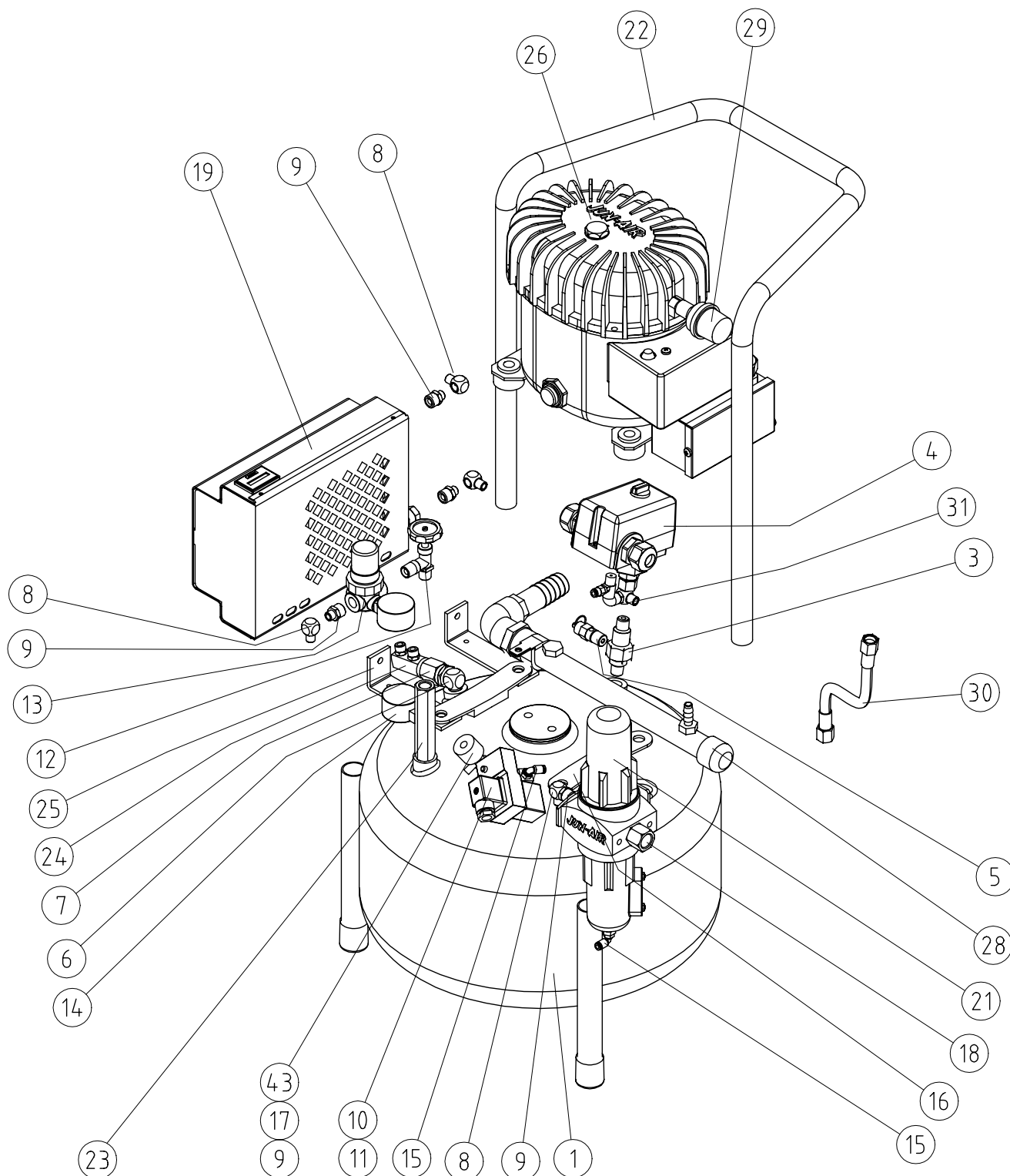

Model CA-713 / CA-723 Parts List

ID#	Description	Part No.	Qty.	ID#	Description	Part No.	Qty.
1	Tank 40L	JA3512200	1	26	Intake filter	JA5412210	2
2	Rubber base compl.	JA6253300	4	27	Motor M6, 240V	JA2021100	2
3	Elbow, 1/4"	JA7180000	3	28	Auto drain, 120V	JA4799600	1
4	Non-return valve	JA5414500	3	29	Radiator & fan w/camtimer 120V	JA5445100	1
5	Cross connector	JA7164200	1	30	Motor M6, 120V	JA2710200	2
6	Safety valve, 135 psi ASME	JA5417000	1	31	Bushing, 1/4" x 1/4"	JA7566000	1
7	Double nipple, 1/4" x 1/8"	JA7025000	4	32	Cross connector	JA7160000	1
8	Extension piece f/cock	JA7156000	1	33	Drain cock 1/4"	JA5420000	1
9	Gauge Ø40, 0-16 bar, 1/8" down	JA5130000	2	34	Fan 240V	JA5451000	2
10	Outlet cock, 1/4"	JA5424000	1	35	Kit repl. valve plate M6 w/top	JA5470310	2
11	Regulator	JA4071020	1	36	Starting relay 120V	JA4524000	2
12	Elbow, 1/8"	JA7190000	2	37	Starting relay 240V	JA4523000	2
13	Bushing, 1/4" x 3/8", NPT inside	JA7567200	1	38	Capacitor 160µF 120V	JA5230000	2
14	Distributor f/non-return valve	JA5425000	1	39	Capacitor 70µF 240V	JA5210000	2
15	Pressure switch	JA5075201	1	40	Overload protector 240V	JA4520000	2
16	Unloader valve	JA6973310	1	41	Overload protector 120V	JA4521000	2
17	Rapid fitting, Ø40 x 1/8"	JA4142200	2	42	Maintenance kit CA-713/723	64568177	1
18	Motor foundation	JA8111500	1	43	Compressed air pipe	JA6490800	1
19	Radiator & fan w/camtimer 240V	JA5445000	1	44	Bushing, 1/4" x 1/2", NPT inside	JA7567300	1
20	T-piece, 1/4"	JA7071300	1	45	Bushing, 1/2" x 3/4", NPT inside	JA7567400	1
21	Rubber clamp, Ø25 mm	JA4383300	2	46	Flex pipe, 1/8", 17(19) cm	JA6417000	1
22	Auto drain, 240V	JA4799500	1	47	Flex pipe, 1/8", 33(35) cm	JA6433000	1
23	Bracket f/filter	JA8006600	1	48	Flex pipe, 1/8", 20(22) cm	JA6420000	2
24	DH combination filter	JA4080000	1	49	Flex pipe, 1/8", 64(66) cm	JA6463000	1
25	Intake pipe	JA5412700	1				

Model CA-713 / CA-723 Diagram

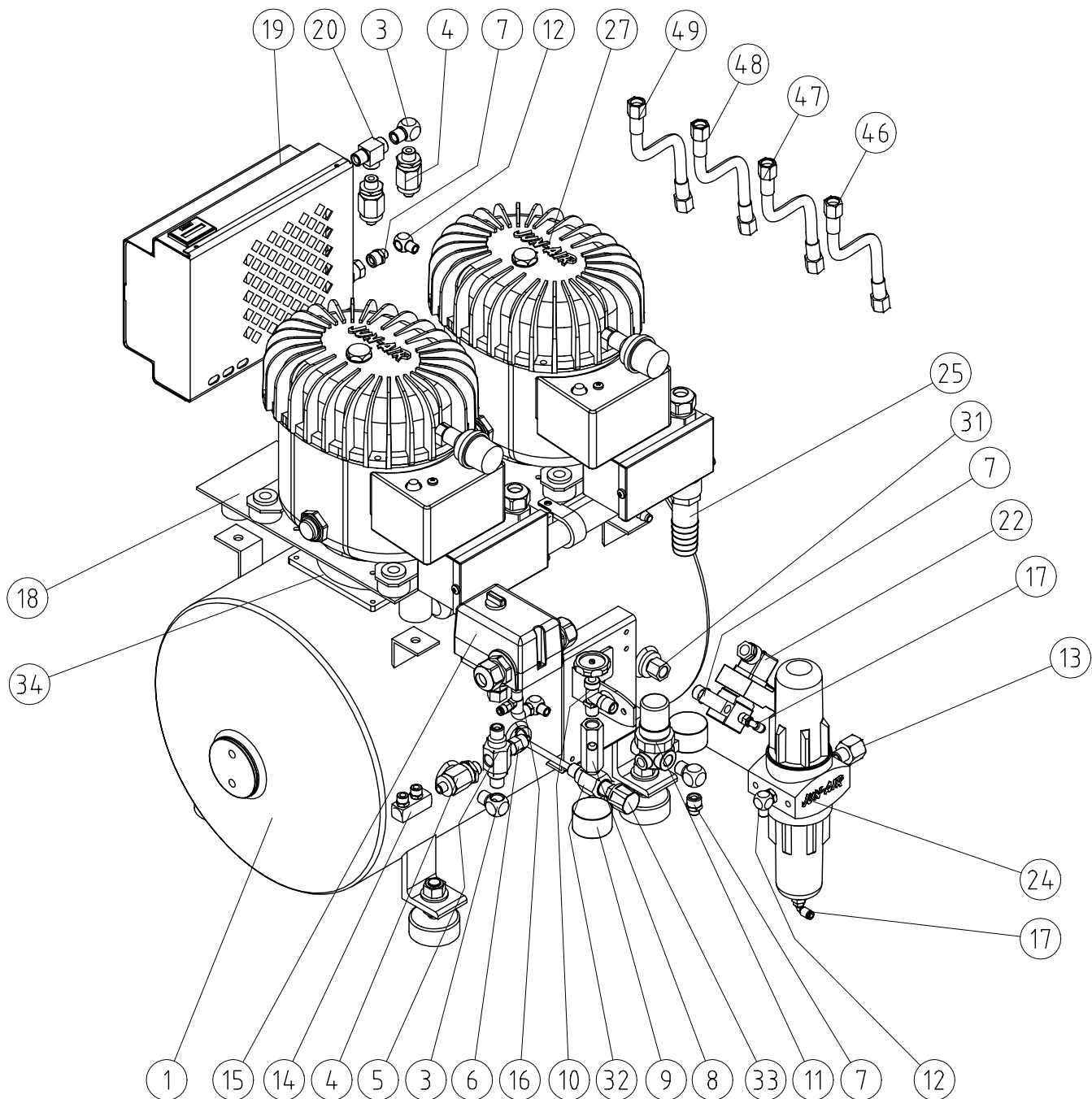

Model CA-725 Parts List

ID#	Description	Part No.	Qty.
1	Tank 40L	JA3512200	1
2	Rubber base compl.	JA6253300	4
3	Elbow, 1/4"	JA7180000	5
4	Non-return valve	JA5414500	5
5	Cross connector	JA7164200	1
6	Safety valve, 135 psi ASME	JA5417000	1
7	Double nipple, 1/4" x 1/8"	JA7025000	4
8	Extension piece f/cock	JA7156000	1
9	Gauge Ø40, 0-16 bar, 1/8" down	JA5130000	2
10	Outlet cock, 1/4"	JA5424000	1
11	Regulator	JA4071020	1
12	Elbow, 1/8"	JA7190000	2
13	Bushing, 1/4" x 3/8", NPT inside	JA7567200	1
14	Distributor f/non-return valve	JA5425000	1
15	Pressure switch	JA5075201	1
16	Unloader valve	JA6973310	1
17	Rapid fitting, Ø4 x 1/8"	JA4142200	2
18	Radiator & fan w/camtimer 240V	JA5445000	1
19	T-piece, 1/4"	JA7071300	1
20	Auto drain, 240V	JA4799500	1
21	Bracket f/filter	JA8006600	1

ID#	Description	Part No.	Qty.
22	DH combination filter	JA4080000	1
23	Intake pipe	JA5412700	2
24	Motor M6, 240V	JA2021100	4
25	Intake filter	JA5412210	4
26	Motor foundation	JA8111600	1
27	Fan 240V	JA545100	4
28	Cross connector 1/4"	JA7160000	1
29	Drain cock 1/4"	JA5420000	1
30	Kit repl. valve plate M6 w/top	JA5470310	4
31	Starting relay 240V	JA4523000	4
32	Capacitor 70µF 240V	JA5210000	4
33	Overload protector 240V	JA4520000	4
34	Compressed air pipe	JA6490800	1
35	Bushing, 1/4" x 1/2", NPT inside	JA7567300	1
36	Bushing, 1/2" x 3/4", NPT inside	JA7567400	1
37	Maintenance kit CA-725	64568178	1
38	Bushing, 1/4" x 1/2"	JA7566000	1
39	Flex pipe, 1/8", 20(22) cm	JA6420000	2
40	Flex pipe, 1/8", 26(28) cm	JA6426000	1
41	Flex pipe, 1/8", 39(41) cm	JA6420000	1
42	Flex pipe, 1/8", 64(66) cm	JA6463000	3

Model CA-725 Diagram

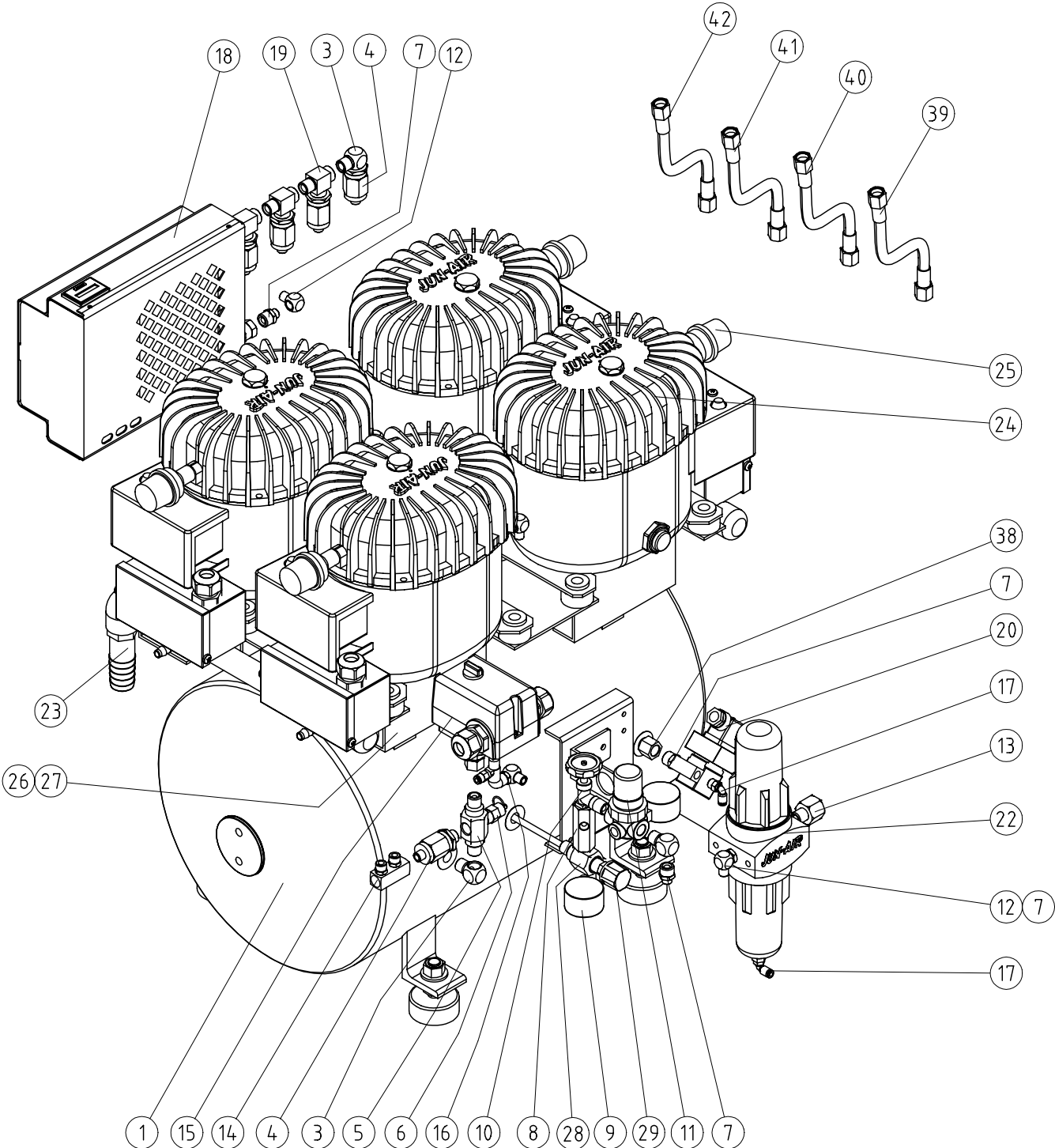

DentalEZ Group

CustomAir Division

700 Series Compressors

DentalEZ and its employees are proud of the products we provide in the dental community. We stand behind these products with a warranty against defects in material and workmanship as provided below. And, we have our own in-house repair facility to service our products.

In the event you experience difficulty with the application or operation of any of our products, please contact our Customer Service Department at **1-866-DTE-INFO (1-866-383-4636)**.

If we cannot resolve the issue by telephone, we will arrange for a technical service representative to contact you or we may suggest that you return the product to our factory for inspection.

If product return is required, we will provide you with a **return merchandise authorization (RMA)** number and shipping instructions for returning the product to the proper facility. Please make sure the **RMA** is included on the package you are returning. Products returned without a **RMA** cannot be repaired or given credit consideration. All **RMAs** are good for 30 days. If the product is under warranty, we will ask you to provide proof of purchase, such as a copy of your invoice.

Freight costs for product returns are the responsibility of the customer. Products under warranty will be repaired or replaced at our sole discretion and returned at our expense. Products outside the warranty limits will be repaired and returned with costs invoiced to the customer. We are not responsible for shipping damages. We will, however, help you file a claim with the freight carrier. Written repair estimates are available. Our out-of-warranty repairs are warranted against defect for a period of six months. In-warranty repairs or replaced products are covered for the duration of the original warranty.

DentalEZ warrants CustomAir Compressors to be free of defects in material and workmanship, under normal usage, for a period of 36 months from the date of installation recorded on the returned warranty card supplied with the equipment.* It is necessary to complete the warranty card and return it to CustomAir immediately. If the warranty card is not returned, warranty starts from the date of factory shipment.

Please note the following additional terms of our warranty and return policy:

- Warranties cover manufacturing defects only and do not cover costs resulting from abuse, improper handling, cleaning, care or maintenance, normal wear and tear or nonobservance of operating, maintenance or installation instructions.
- Liability is limited to repair or replacement of the defective product at our sole discretion. All other liabilities, in particular liability for damages, including, without limitation, consequential or incidental damages are excluded.
- THIS WARRANTY IS IN LIEU OF ALL OTHER WARRANTIES, EXPRESSED OR IMPLIED, INCLUDING THE WARRANTIES OF MERCHANTABILITY OR FITNESS FOR A PARTICULAR PURPOSE. NO EMPLOYEE, REPRESENTATIVE OR DEALER IS AUTHORIZED TO CHANGE THIS WARRANTY IN ANY WAY OR TO GRANT ANY OTHER WARRANTY.

** Provided conditions defined in the Installation, Operation and Care Manual are met.*

DentalEZ and CustomAir are trademarks of DentalEZ Group.
© 2001 Den-Tal-Ez, Inc.

