



A HIGHER STANDARD

1440 Don Mills Road
Toronto Ontario
Canada M3B 3P9
Tel. (416) 445-1600
Fax: (416) 445-2727

Technical Service Bulletin

Thursday, April 9, 2009

Product Support

Canada X

Europe & International X

USA X

T.S.B. Number:

09-TSB-271

Description:

**Checking the Statim 7000
Proximity (Magnetic) Switch**

09-TSB-271 Checking the Statim 7000 Proximity (Magnetic) Switch

- Ensure the unit is powered off.
 - Ensure the water filter (brand new or just primed but not old) is installed.
 - Ensure the water reservoir is installed.
 - Ensure water is filled to the MAX mark in the reservoir.
1. Enter the Service Menu by pressing and holding “wrapped” and “unwrapped” button and turning on the power switch



2. Enter service password: “unwrapped”, “wrapped”, “unwrapped”, “wrapped”
3. Choose and enter “>Conductivity Setup”

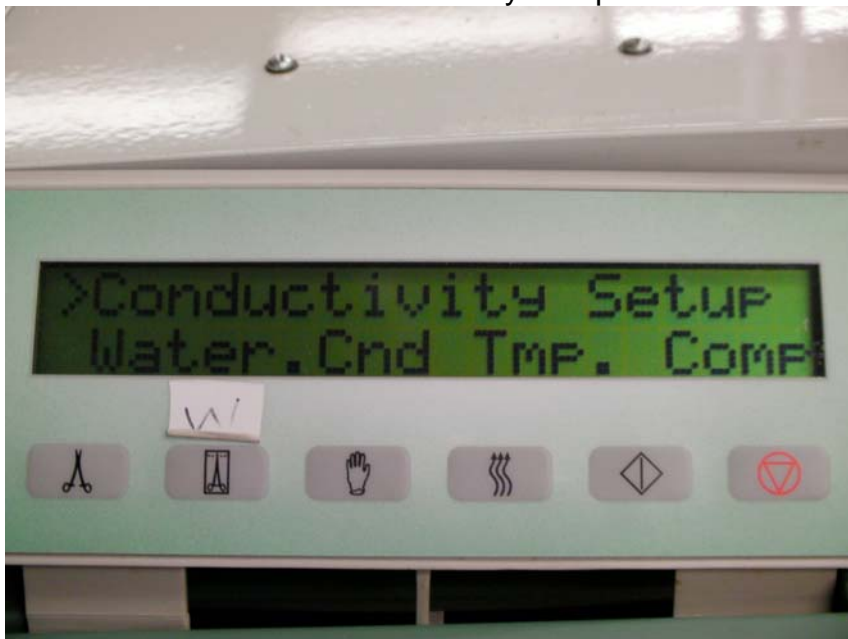

4. Read and understand the 2nd line

- 1st character = Water Level Indication
- 2nd character = Reservoir Indication

Water Level = Low

Water Reservoir = Not Installed



Water Level = OK

Water Reservoir = Not Installed



Water Level = Low

Water Reservoir = Installed

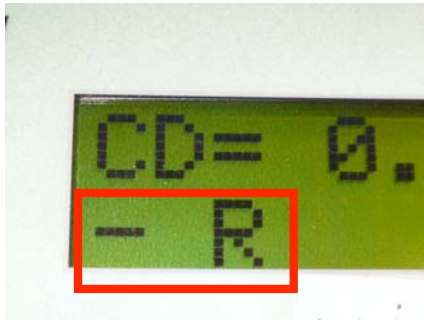

Water Level = OK

Water Reservoir = Installed

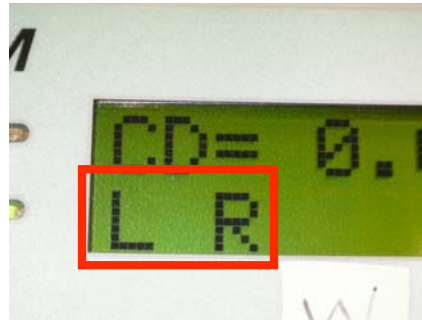

5. If the display does not indicate “L R”, empty the water reservoir and hold it with the reservoir outlet facing down;

- Loosen the screw with a Philips screwdriver so that the magnet is free to move inside the compartment.
- Make sure the magnet is sitting on the bottom surface of the compartment.
- Tighten the screw again to secure the magnet.

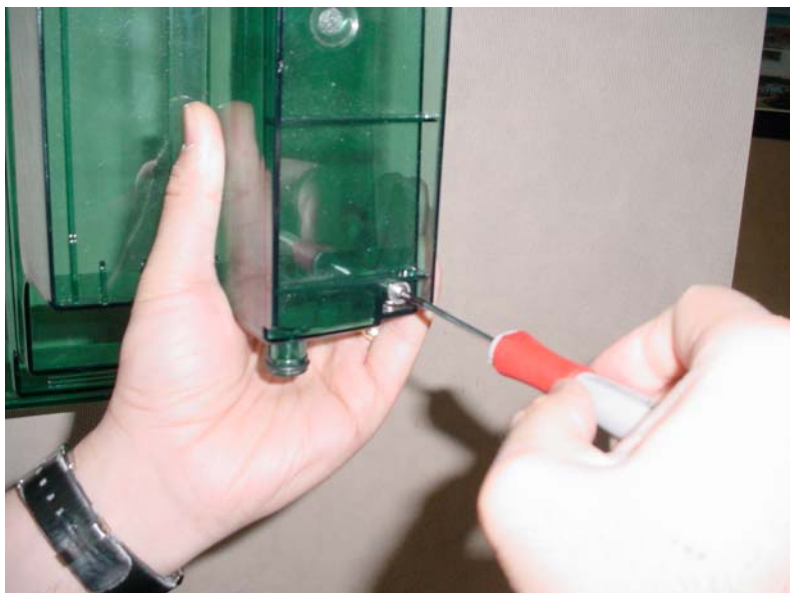

6. Reinstall the water filter and a full reservoir;
 - Check the “>Conductivity Setup” again
 - If the display still does not indicate “L R”, then proceed to step 7 to check the wires.
7. Remove the cover and check the connection on the PCB to ensure the wires are properly installed and tightened.

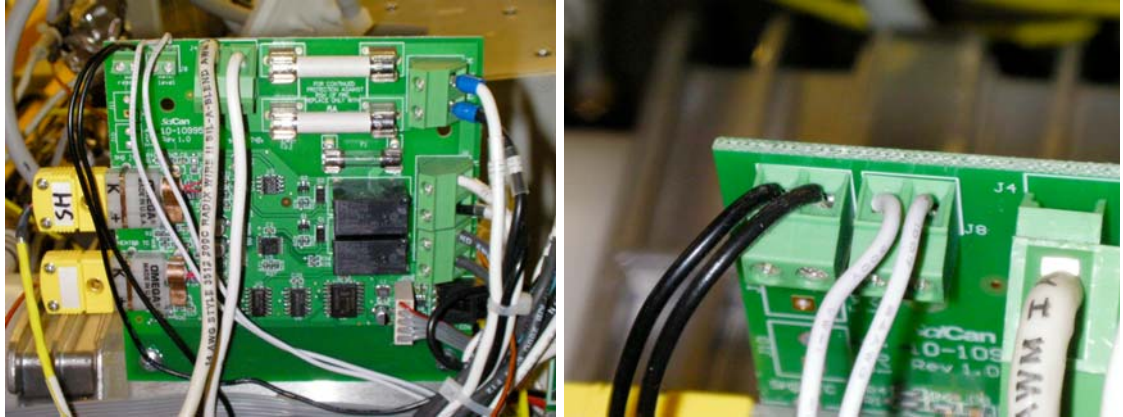

8. Replace the cover and tighten all front screws to ensure that the reservoir compartment is in the correct position, then reinstall the water filter and a full reservoir;
 - Check the “>Conductivity Setup” again
 - If the unit shows “L -” or “- -”, remove the cover
 - install the same filter and full reservoir and check the “>Conductivity Setup” again. *Ensure you have a block under the filter so the filter is level with machine.*
 - If the unit shows “L R” or “- R”, then you may need to adjust the magnet and the proximity (magnetic) switch – go to step 9.
9. Mark the proximity switch body and front nut with a marker or correction fluid.



- Loosen the rear nut with a ½" or 13 mm wrench by rotating the wrench clockwise.

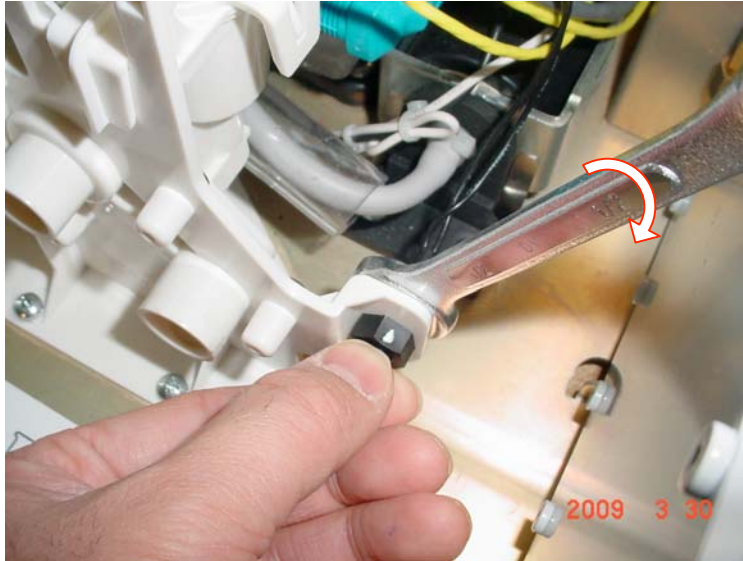

- Rotate the front nut clockwise by ½ turn (mark rotates from top to bottom) while holding the reed switch body firmly. This will move the switch forward.

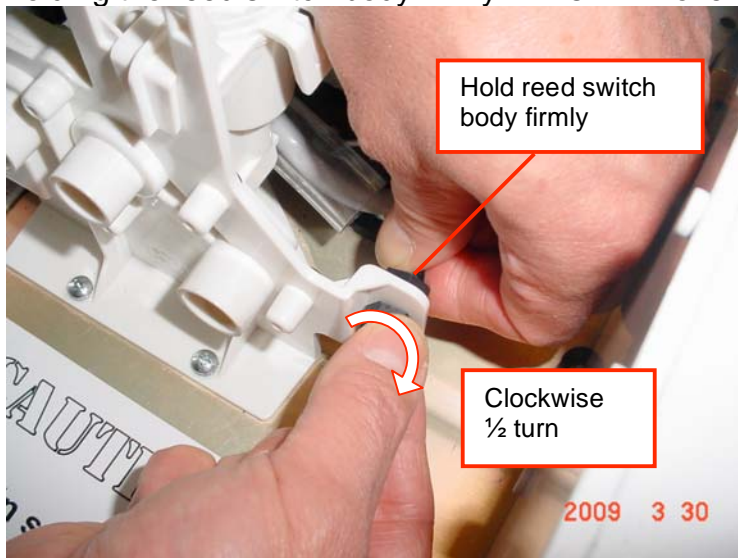

- Tighten the rear nut manually (counterclockwise) while holding the front nut and reed switch body firmly.

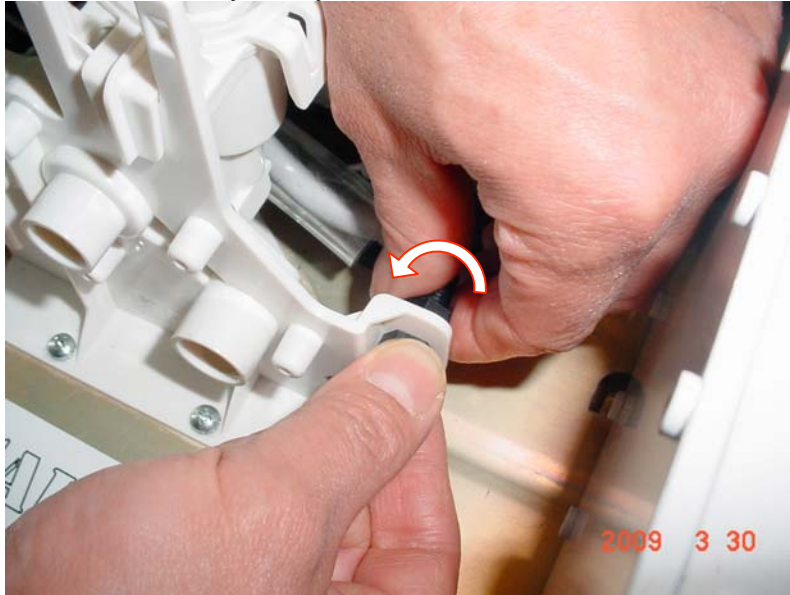

- Tighten the rear nut (counterclockwise) by another 1/6 turn (one flat) using a wrench. Hold front nut and reed switch body firmly while tightening the rear nut. Do not over tighten the nut as it could damage the proximity sensor.

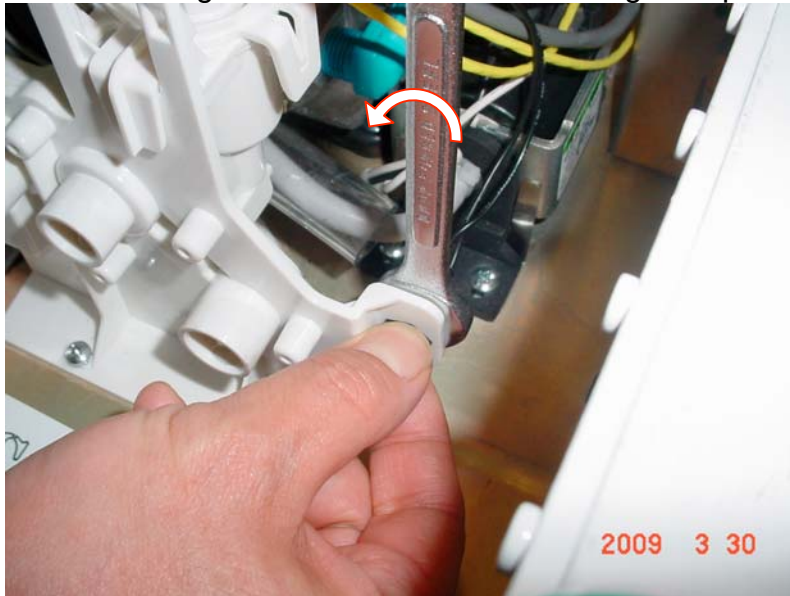

10. Replace the cover and tighten all front screws to ensure that the reservoir compartment is in the correct position, then reinstall the water filter and a full reservoir;
 - Check the ">Conductivity Setup" again
 - If the unit still shows "L -" or "- -", remove the cover and perform step 9 again (another 1/2 turn) until the unit shows "L R" or "- R". Do NOT adjust the reed switch front nut by more than one turn (2x 1/2 turns) total. If the second 1/2 turn adjustment does not resolve the problem, the reed switch may be damaged and the water receiver assembly needs to be replaced.
 - Once you see the R when the cover is replaced, the proximity switch is adjusted.
 - Fill the reservoir with water and the display should be "L R".